

Scanning distance
10 ... 50 mm

Luminescence scanners

- UV semi-conductor light source
- No lamp replacement
- Scanning distance selectable by using interchangeable lenses

Dimensional drawing

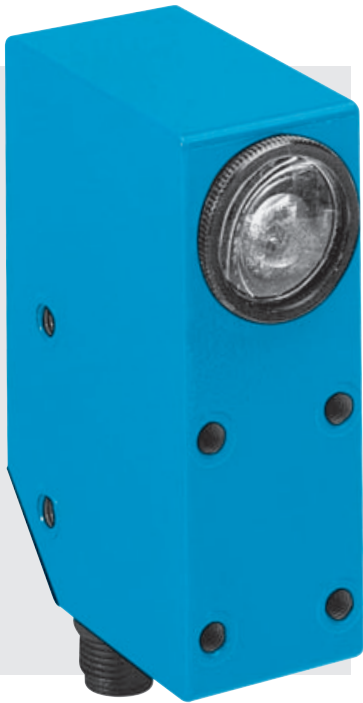
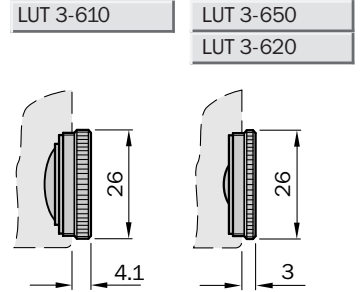
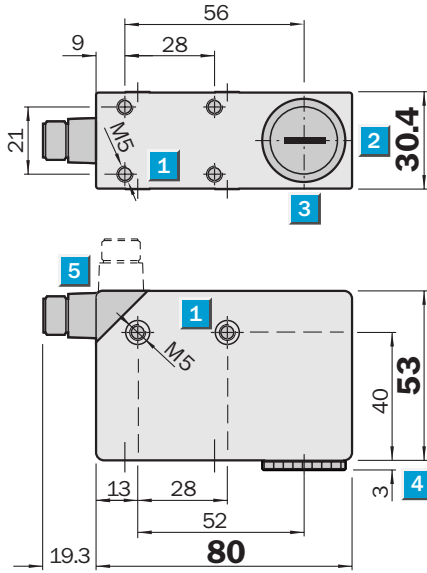

Adjustments possible

All types

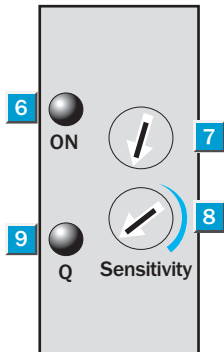

- 1 M5 threaded mounting hole, 5.5 mm deep
- 2 Light spot direction
- 3 Centre of optical axis
- 4 See dimensional drawing for lens
- 5 M12 plug (rotatable)
- 6 Operating indicator
- 7 Not used
- 8 Sensitivity adjustment
- 9 Output indicator

Connection type

All types

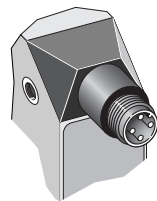

4-pin, M12

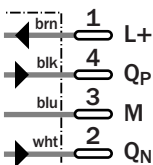

Accessories

Connectors
Mounting systems
Lenses



Technical data		LUT3-	610	620	650						
Scanning distance¹⁾/light spot sizes	10 mm/∅ 2 x 6 mm										
	20 mm/∅ 3 x 9 mm										
	50 mm/∅ 5 x 15 mm										
Light spot direction	Longitudinal										
Light source²⁾, light type	UV light source										
Wavelength	385 nm										
Supply voltage V_s	12 ... 30 V DC ³⁾										
Ripple ⁴⁾	max. 2 V										
Current consumption ⁵⁾	60 mA										
Switching outputs	Light-switching										
	PNP: HIGH = V _s - <3 V / LOW = 0 V										
	NPN: HIGH = V _s / LOW = <2 V										
Output current I _A max.	100 mA										
Response time ⁶⁾	0.3 ms										
Switching frequency ⁷⁾	1.5 kHz										
Connection type	Plug										
VDE protection class⁸⁾	□										
Circuit protection⁹⁾	A, B, C										
Enclosure rating	IP 67										
Ambient temperature T_A	Operation -10 °C ... +55 °C										
	Storage -25 °C ... +75 °C										
Shock load	To IEC 68										
Weight	400 g										
Housing material	Die-cast metal										

- ¹⁾ From front edge of lens
- ²⁾ Average service life 100,000 h at T_A = +25 °C
- ³⁾ Limit values
- ⁴⁾ May not exceed or fall short of V_s tolerances
- ⁵⁾ Without load
- ⁶⁾ Signal transit time with resistive load
- ⁷⁾ With light/dark ratio 1:1
- ⁸⁾ Reference voltage 50 V DC
- ⁹⁾ A = V_s connections reverse-polarity protected
 B = Outputs Q_p und Q_N short-circuit protected
 C = Interference pulse suppression

Scanning distance		Order information								
1 Scanning distance 10 mm	<p>Scan material: SICK Luminescence scale 100%</p>	<table border="1" style="width: 100%; border-collapse: collapse;"> <thead> <tr> <th>Type</th> <th>Order no.</th> </tr> </thead> <tbody> <tr> <td>LUT3-610</td> <td>1 015 396</td> </tr> <tr> <td>LUT3-620</td> <td>1 015 397</td> </tr> <tr> <td>LUT3-650</td> <td>1 015 398</td> </tr> </tbody> </table>	Type	Order no.	LUT3-610	1 015 396	LUT3-620	1 015 397	LUT3-650	1 015 398
Type		Order no.								
LUT3-610		1 015 396								
LUT3-620	1 015 397									
LUT3-650	1 015 398									
2 Scanning distance 20 mm		<table border="1" style="width: 100%; border-collapse: collapse;"> <thead> <tr> <th colspan="2">LUT3-6 is not supplied with additional filter or fibre-optic cable</th> </tr> </thead> <tbody> <tr> <td>OBJ-LUT3-10</td> <td>2 016 348</td> </tr> <tr> <td>OBJ-LUT3-20</td> <td>2 016 349</td> </tr> <tr> <td>OBJ-LUT3-50</td> <td>2 016 350</td> </tr> </tbody> </table>	LUT3-6 is not supplied with additional filter or fibre-optic cable		OBJ-LUT3-10	2 016 348	OBJ-LUT3-20	2 016 349	OBJ-LUT3-50	2 016 350
LUT3-6 is not supplied with additional filter or fibre-optic cable										
OBJ-LUT3-10	2 016 348									
OBJ-LUT3-20	2 016 349									
OBJ-LUT3-50	2 016 350									
3 Scanning distance 50 mm										