



Photoelectric sensors
Energetic, Photoelectric proximity sensor,
Product group W9-2

WT9-2N160



Model Name > [WT9-2N160](#)
Part No. > [1019342](#)



- Emitter LED IR
- Scanning distance adjustable
- Switching frequency 500/s
- Outputs short-circuit protected
- Permissible ambient operating temperature -40°C...+60°C

The product has been discontinued. Please contact your SICK sales representative for more information about a replacement product.



Product features

Sensing range min ... max::	50 mm ... 1,500 mm
Light source:	LED
Type of light:	Infrared light
Light spot diameter:	600 mm at 1500 mm distance
Laser:	Infrared light
Sensing range max.:	50 mm ... 1,500 mm
Relating to:	Object with 90 % reflectance (referred to standard white DIN 5033)
Adjustment::	Potentiometer

Technical data

Design::	Rectangular
Dimensions (W x H x D):	12 mm x 40 mm x 22 mm
Supply voltage min ... max:	DC 10 ... 30 V ¹⁾
Residual ripple:	≤ 5 Vpp
Power consumption:	≤ 30 mA
Output type:	NPN antivalent
Signal voltage NPN HIGH/LOW:	Vs/
Output current max.:	≤ 100 mA
Response time:	≤ 1,000 μs
Switching frequency::	500 Hz
Connection type:	Cable, 2 m
Number of cores:	4
Conductor size:	0.14 mm ²
Circuit protection:	V _s connections reverse-polarity protected/All outputs short-circuit protected/Interference suppression
Enclosure rating::	IP 67: EN 60529, IP 69K: EN 40050

Ambient operation temperature, min ... max: -40 °C ... +60 °C
 Ambient storage temperature, min ... max: -40 °C ... +75 °C
 Weight: Ca. 80 g
 Series: W9-2
 Front screen heating: -
 UL File No.: NRKH.E181493 & NRKH7.E181493

1) Limit values

Masszeichnung

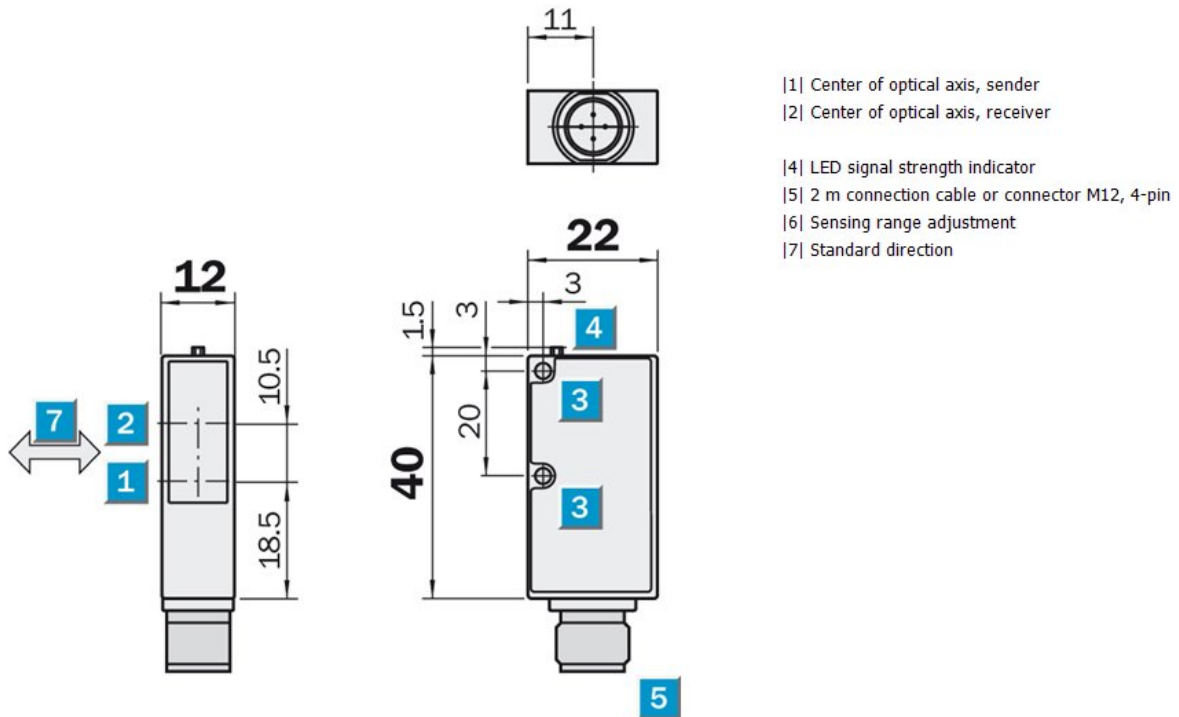

- |1| Center of optical axis, sender
- |2| Center of optical axis, receiver
- |4| LED signal strength indicator
- |5| 2 m connection cable or connector M12, 4-pin
- |6| Sensing range adjustment
- |7| Standard direction

Einstell-Möglichkeiten

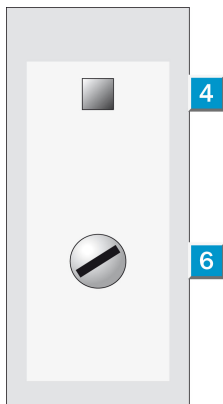

Anschlussart

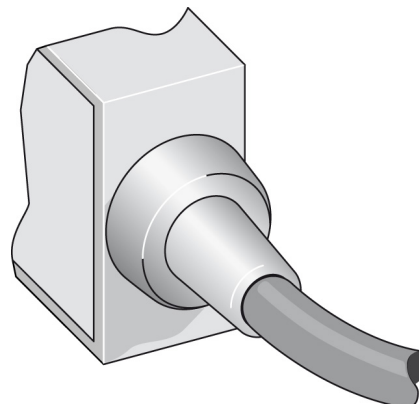

Anschluss-Schema

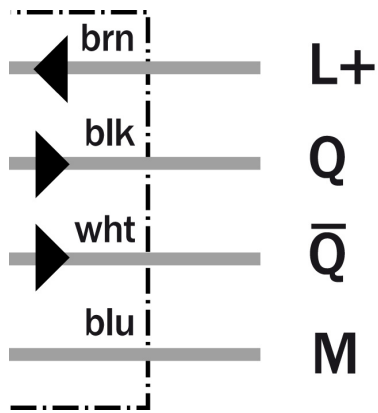

Schaltabstand-Diagramm

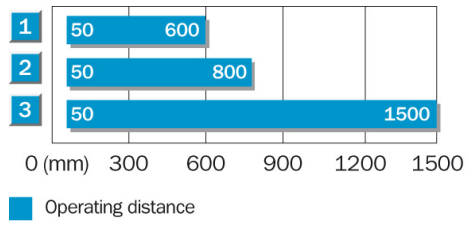

- | | |
|---|---|
| 1 | Scanning range on black, 6 % remission |
| 2 | Scanning range on gray, 18 % remission |
| 3 | Scanning range on white, 90 % remission |

Australia

Phone +61 3 9457 0600
1800 334 802 – tollfree
E-Mail sales@sick.com.au

Belgium/Luxembourg

Phone +32 (0)2 466 55 66
E-Mail info@sick.be

Brasil

Phone +55 11 3215-4900
E-Mail sac@sick.com.br

Canada

Phone +1 905 771 14 44
E-Mail information@sick.com

Česká republika

Phone +420 2 57 91 18 50
E-Mail sick@sick.cz

China

Phone +86 4000 121 000
E-Mail info.china@sick.net.cn
Phone +852-2153 6300
E-Mail ghk@sick.com.hk

Danmark

Phone +45 45 82 64 00
E-Mail sick@sick.dk

Deutschland

Phone +49 211 5301-301
E-Mail info@sick.de

España

Phone +34 93 480 31 00
E-Mail info@sick.es

France

Phone +33 1 64 62 35 00
E-Mail info@sick.fr

Great Britain

Phone +44 (0)1727 831121
E-Mail info@sick.co.uk

India

Phone +91-22-4033 8333
E-Mail info@sick-india.com

Israel

Phone +972-4-6801000
E-Mail info@sick-sensors.com

Italia

Phone +39 02 27 43 41
E-Mail info@sick.it

Japan

Phone +81 (0)3 3358 1341
E-Mail support@sick.jp

Magyarország

Phone +36 1 371 2680
E-Mail office@sick.hu

Nederland

Phone +31 (0)30 229 25 44
E-Mail info@sick.nl

Norge

Phone +47 67 81 50 00
E-Mail sick@sick.no

Österreich

Phone +43 (0)22 36 62 28 8-0
E-Mail office@sick.at

Polska

Phone +48 22 837 40 50
E-Mail info@sick.pl

România

Phone +40 356 171 120
E-Mail office@sick.ro

Russia

Phone +7-495-775-05-30
E-Mail info@sick.ru

Schweiz

Phone +41 41 619 29 39
E-Mail contact@sick.ch

Singapore

Phone +65 6744 3732
E-Mail sales.gsg@sick.com

Slovenija

Phone +386 (0)1-47 69 990
E-Mail office@sick.si

South Africa

Phone +27 11 472 3733
E-Mail info@sickautomation.co.za

South Korea

Phone +82 2 786 6321/4
E-Mail info@sickkorea.net

Suomi

Phone +358-9-25 15 800
E-Mail sick@sick.fi

Sverige

Phone +46 10 110 10 00
E-Mail info@sick.se

Taiwan

Phone +886-2-2375-6288
E-Mail sales@sick.com.tw

Türkiye

Phone +90 (216) 528 50 00
E-Mail info@sick.com.tr

United Arab Emirates

Phone +971 (0) 4 8865 878
E-Mail info@sick.ae

USA/México

Phone +1(952) 941-6780
1 800-325-7425 – tollfree
E-Mail info@sickusa.com

More representatives and agencies
at www.sick.com