



CE

Model Number

NJ8-18GM50-E2

Features

- Comfort series
- 8 mm not embeddable

Connection

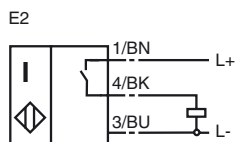

Dimensions

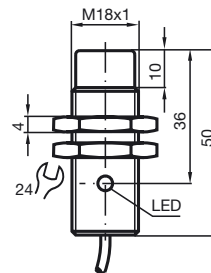

Technical Data

General specifications

Switching element function	PNP Make function
Rated operating distance	s_n 8 mm
Installation	not embeddable
Output polarity	DC
Assured operating distance	s_a 0 ... 6.48 mm
Reduction factor r_{AI}	0.42
Reduction factor r_{Cu}	0.4
Reduction factor r_{V2A}	0.72

Nominal ratings

Operating voltage	U_B	10 ... 60 V
Switching frequency	f	0 ... 1000 Hz
Hysteresis	H	1 ... 15 typ. 7.5 %
Reverse polarity protection		protected against reverse polarity
Short-circuit protection		pulsing
Voltage drop	U_d	≤ 3 V
Operating current	I_L	0 ... 200 mA
Off-state current	I_r	0 ... 0.5 mA typ. 0.01 mA
No-load supply current	I_0	≤ 9 mA
Indication of the switching state		LED, yellow

Standard conformity

Standards	IEC / EN 60947-5-2:2004
-----------	-------------------------

Ambient conditions

Ambient temperature	-25 ... 70 °C (248 ... 343 K)
Storage temperature	-40 ... 85 °C (233 ... 358 K)

Mechanical specifications

Connection type	2 m, PVC cable
Core cross-section	0.5 mm ²
Housing material	Stainless steel
Sensing face	PBT
Protection degree	IP67