

Comfort series
5 mm embeddable

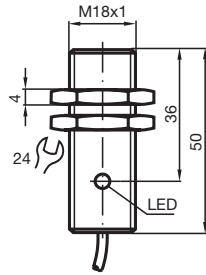

Switching element function	NPN	Make function
Rated operating distance s_n	5 mm	
Installation	embeddable	
Assured operating distance s_a	0 ... 4,05 mm	
Reduction factor r_{AI}	0,2	
Reduction factor r_{Cu}	0,15	
Reduction factor r_{V2A}	0,62	
Mounting conditions		
A	0 mm	
B	0 mm	
C	15 mm	
Operating voltage U_B	10 ... 60 V	
Switching frequency f	0 ... 1500 Hz	
Hysteresis H	1 ... 15 typ. 6 %	
Reverse polarity protection	yes	
Short circuit protection	pulsing	
Voltage drop U_d	≤ 3 V	
Operating current I_L	0 ... 200 mA	
Off-state current I_r	0 ... 0,5 mA typ. 0,01 mA	
No-load supply current I_0	≤ 9 mA	
Indication of the switching state	LED, yellow	
Standards	EN 60947-5-2	
Ambient temperature	-25 ... 70 °C (248 ... 343 K)	
Storage temperature	-40 ... 85 °C (233 ... 358 K)	
Connection type	2 m, PVC cable	
Core cross-section	0.5 mm ²	
Housing material	high grade steel	
Sensing face	PBT	
Protection degree	IP67	

Connection_type:

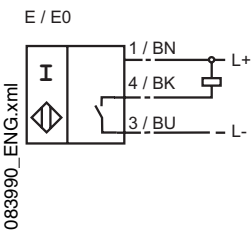

2003-03-24

www.pepperl-fuchs.com

PEPPERL+FUCHS GmbH