



Model Number

NEB12-18GM50-E-V1

Features

- Comfort series
- 12 mm quasi-embeddable
- increased operating distance

Connection

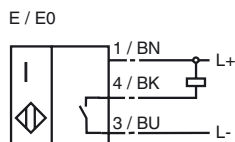

Accessories

BF 18

Mounting flange

V1-G

Non pre-wired cable socket

V1-W

Non pre-wired cable socket

V1-G-2M-PUR

Cable connector

V1-W-2M-PUR

Cable connector

Dimensions

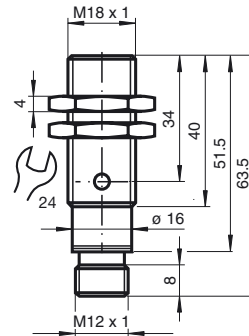

Technical Data

General specifications

Switching element function	NPN Make function
Rated operating distance	s_n 12 mm
Installation	quasi embedd.
Output polarity	DC
Assured operating distance	s_a 0 ... 9.72 mm
Reduction factor r_{AI}	0.26
Reduction factor r_{Cu}	0.2
Reduction factor r_{V2A}	0.63

Nominal ratings

Operating voltage	U_B	10 ... 30 V
Switching frequency	f	0 ... 500 Hz
Hysteresis	H	typ. 5%
Reverse polarity protection		protected against reverse polarity
Short-circuit protection		yes
Voltage drop	U_d	≤ 2 V
Operating current	I_L	0 ... 200 mA
Off-state current	I_r	0 ... 0.1 mA typ. 0.1 μ A at 25 °C
No-load supply current	I_0	≤ 10 mA
Indication of the switching state		LED yellow

Standard conformity

Standards	IEC / EN 60947-5-2:2004
-----------	-------------------------

Ambient conditions

Ambient temperature	-25 ... 70 °C (248 ... 343 K)
---------------------	-------------------------------

Mechanical specifications

Connection type	V1-connector
Housing material	brass, chromium plated
Sensing face	PBT
Protection degree	IP67