



CE

Model Number

NBB5-18GM50-E0

Features

- Basic series
- 5 mm embeddable

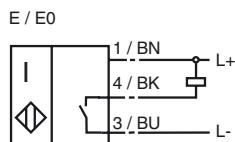
Connection**Accessories****BF 18**

Mounting flange

EXG-18

Mounting aid

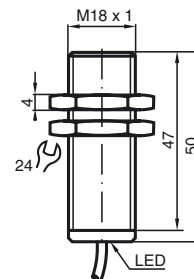
Dimensions**Technical Data****General specifications**

Switching element function	NPN Make function
Rated operating distance	s_n 5 mm
Installation	embeddable
Output polarity	DC
Assured operating distance	s_a 0 ... 4.05 mm
Reduction factor r_{Al}	0.3
Reduction factor r_{Cu}	0.3
Reduction factor r_{V2A}	0.7
Reduction factor r_{St37}	

Nominal ratings

Operating voltage	U_B	10 ... 30 V
Switching frequency	f	0 ... 800 Hz
Reverse polarity protection		protected against reverse polarity
Short-circuit protection		pulsing
Voltage drop	U_d	≤ 3 V
Operating current	I_L	0 ... 200 mA
Off-state current	I_r	0 ... 0.5 mA typ. 0.1 μ A at 25 °C
No-load supply current	I_0	≤ 20 mA
Indication of the switching state		all direction LED, yellow

Standard conformity

Standards	IEC / EN 60947-5-2:2004
-----------	-------------------------

Ambient conditions

Ambient temperature	-25 ... 70 °C (248 ... 343 K)
---------------------	-------------------------------

Mechanical specifications

Connection type	2 m, PVC cable
Core cross-section	0.34 mm ²
Housing material	brass, nickel-plated
Sensing face	PBT
Protection degree	IP67