



CE

**Model Number**

NBB10-30GM50-E0

**Features**

- Basic series
- 10 mm embeddable

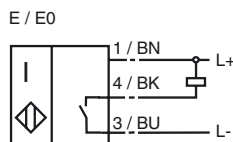
**Connection****Accessories****BF 30**

Mounting flange

**EXG-30**

Mounting aid

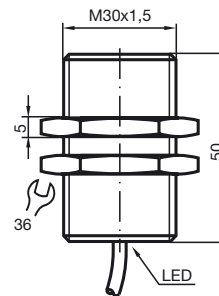
**Dimensions****Technical Data****General specifications**

Switching element function	NPN Make function
Rated operating distance	$s_n$ 10 mm
Installation	embeddable
Output polarity	DC
Assured operating distance	$s_a$ 0 ... 8.1 mm
Reduction factor $r_{AI}$	0.3
Reduction factor $r_{Cu}$	0.3
Reduction factor $r_{V2A}$	0.8

**Nominal ratings**

Operating voltage	$U_B$	10 ... 30 V
Switching frequency	$f$	0 ... 200 Hz
Hysteresis	$H$	typ. 5%
Reverse polarity protection		protected against reverse polarity
Short-circuit protection		pulsing
Voltage drop	$U_d$	$\leq 3$ V
Operating current	$I_L$	0 ... 200 mA
Off-state current	$I_r$	$\leq 10$ $\mu$ A
No-load supply current	$I_0$	$\leq 20$ mA
Indication of the switching state		all direction LED, yellow

**Standard conformity**

Standards	IEC / EN 60947-5-2:2004
-----------	-------------------------

**Ambient conditions**

Ambient temperature	-25 ... 70 °C (248 ... 343 K)
---------------------	-------------------------------

**Mechanical specifications**

Connection type	2 m, PVC cable
Core cross-section	0.34 mm <sup>2</sup>
Housing material	brass, nickel-plated
Sensing face	PBT
Protection degree	IP67